



Strato ceilings

Strato ceilings are made up of varying proportions of different panels. They lend real architectural freedom to the process of ceiling design.

The panels can be opaque or open mesh, acoustic or technical, in different sizes and with different functions. They are chosen and put together to form islands or continuous ceilings depending on the performance and appearance required. This modular design capacity makes it possible to create ceilings for a complete volume or area by area.

Strato ceilings are easy on the eye and invitingly warm, while being light, but robust. They are easy to install and maintain.

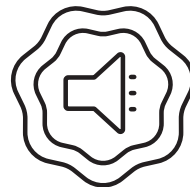

$\alpha_w = 1$ (Stereo
suspended in clusters)



Run-resistant,
antistatic knit

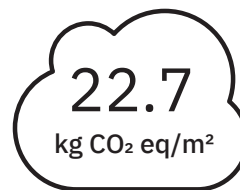

Impact on climate
(Stereo acoustic panels)



Recycled components
(Stereo acoustic panels)



Learn more

Acoustic and technically versatile

Strato ceilings provide limitless combinations to improve the acoustics of a whole space, or area by area. Designers can choose the different elements to assemble them together and achieve the required acoustic performance, while integrating all types of technical systems (lighting, ventilation, etc.).

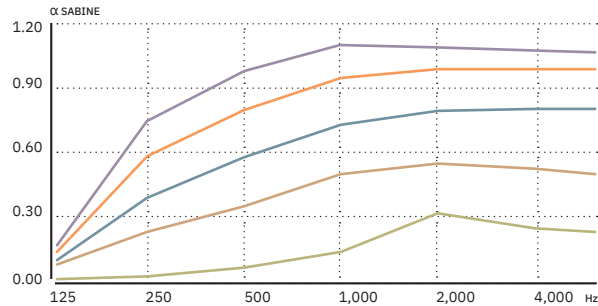

Acoustic performance

Performance of panels with dimensions of 1,199 x 1,199 x 55 mm
 α Sabine – suspended in clusters 300 mm below the masonry ceiling

- 100% acoustic panels
- 75% acoustic panels + 25% open mesh panels
- 50% acoustic panels + 50% open mesh panels
- 25% acoustic panels + 75% open mesh panels
- 100% open mesh panels



Made up of Stereo acoustic panels in clusters, Strato ceilings can correct the acoustics of large reverberating spaces.

Endress Hauser Flowtec AG in Cernay in northeastern France. *Emergence architecture.*



Made up of Stereo Air open mesh panels, the Strato system unifies ceilings. It conceals smoke detectors and air vents, while allowing the light through from lighting systems.

Sauternes building of Sciences Po Agro institute in Gradignan near Bordeaux.
Architect: Jean Philippe Gras.



A Strato ceiling consisting of Stereo acoustic panels and Stereo Air open mesh panels.

Anthos building in Boulogne-Billancourt in western Paris.
Élizabeth Naud & Luc Poux associated architects.



A Strato ceiling. The light sources are installed above the Stereo Air open mesh panels, enabling them to be discretely integrated, while generating soft, warm light.

Meeting room in the Bordeaux offices of Moon Safari architects and urban planners.







A Strato ceiling comprising clusters of Stereo acoustic panels. Nîmes Pont-du-Gard train station in southern France. Project architect: Pascale Guenand for *SNCF Gares&Connexions* / *AREP*.



Strato ceiling. Head office of Ligeris real estate in Tours, northwestern France. Designed by *iwoodlove* and *Agence Pigment*.



A Strato ceiling made up of Stereo acoustic panels in clusters with integrated lighting and loudspeakers. Brighton College Performing Arts Centre. Architect: Ashleigh Sullivan of *krft B.V.*





A Strato ceiling made-up of Stereo Air open mesh panels and Stereo acoustic panels with an alternating light system.

Hilti offices in London, UK. Architect: Peter Pringle of TP Bennett.



A Strato ceiling comprising Stereo Air open mesh panels and Stereo acoustic panels, featuring the inclusion of lights.

Technicolor Animation Productions in Paris. *Studios Architecture.*







Strato ceiling made-up of Stereo acoustic panels in clusters.
Tasting room of Château Gruaud-Larose in Saint-Julien
Beychevelle, north of Bordeaux. Architects: Lanoire & Courrian.



Strato ceiling made up of Stereo acoustic panels in clusters.
New Saint-Jacques-Les Andély's general hospital. Architect:
Jean-Michel Dufour and Elisabeth Goldman Ad Quatio.





Installation

Fastenings are carefully selected to make installation easy. The panels are light and easy to install suspended from the ceiling by cables whose lengths can be adjusted.



Manufactured
in France



Craftsmanship



Guaranteed
10 years

How they are installed

Connecting components make it possible to join panels together precisely and invisibly, simply by overlapping them. Very large areas can be fitted with perfect flatness and regularity.



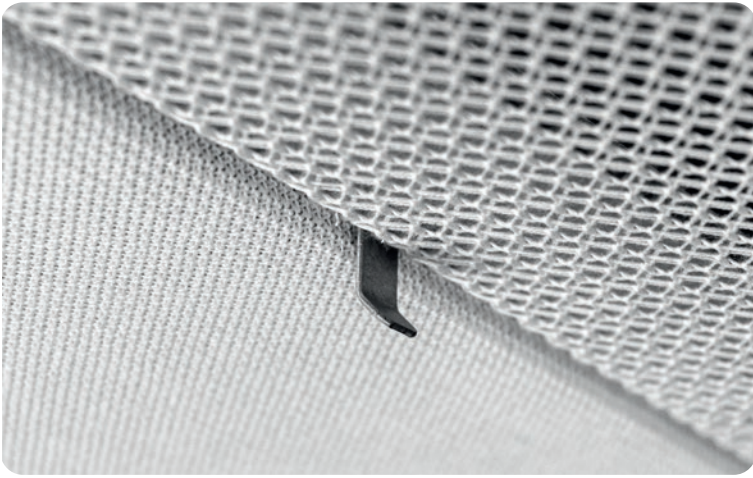

Access hatches

When needed, an acoustic or open mesh panel can become an invisible access hatch, which in no way changes the appearance of the ceiling and gives easy access to the area above. An inconspicuous latch holds it closed.



Characteristics

Strato ceilings are designed to be able to combine two components: Stereo acoustic panels and Stereo Air open mesh panels, as well as the many different accessories described above.

STEREO AIR PANELS



- Rustproof steel frame
- Sound-transparent Aeria fabric cover



43% recycled components



Light transmission
(for colour GMR006 *Gris Anthracite*):

- 52% from a spotlight positioned between 50 and 1,600 mm from the panel
- 55% from a light panel positioned between 50 and 1,600 mm from the panel

Light transmission
(for colour GMR003 *Gris Nacré*):

- 54% from a spotlight positioned between 50 and 1,600 mm from the panel
- 91% from a light panel positioned 50 mm from the Stereo Air panel and 67% when the light panel is positioned 1,600 mm from it.



Absorption coefficient
 $\alpha_w = 0.15$, NRC = 0.15, classe E



Complete product: B-s1,d0
United States – ASTM Class A



Run-resistant knit, 190 g/m²,
antistatic



Impact on climate:
14.2 kg CO₂ eq /m²



HQE, LEED
and BREEAM (4 points)

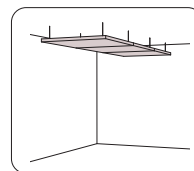

Suspended connected

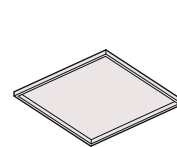

1,199 x 1,199 x 55 mm

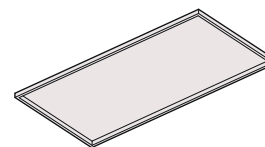

1,199 x 2,399 x 55 mm

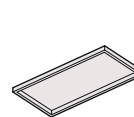

599 x 1,199 x 55 mm

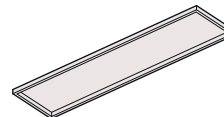

599 x 2,399 x 55 mm



- Air permeability according to ISO 9237:
6,596 l/m²/s
- Porosity: 54%



French “A+” interior air quality
AgBB compliant



End of life: can be dismantled. Components
are separable and recyclable.



Select from the 2 colours
in the Aeria GMR palette. Special
colours available on request.

Updates and technical
data sheets on [texaa.com](https://www.texaa.com)





SOUND-ABSORBING STEREO PANELS



- Rustproof steel frame
- Fully recycled white AF1 wadding
- Grey or black microporous cloth
- Removable sound-transparent Aeria fabric cover



Equivalent absorption area $A(m^2)$
at mid-range frequencies

- Stereo 1,199-mm x 1,199-mm x 55-mm
suspended panel: 2 m²



57% recycled components



Complete product: B-s2,d0
United States - ASTM Class A



Run-resistant knit, 330 g/m²,
antistatic



Impact on climate:
22.7 kg CO₂ eq /m²



HQE, LEED
and BREEAM (4 points)



End of life: can be dismantled. Components
are separable and recyclable.



French "A+" interior air quality
AgBB compliant
Indoor Air Comfort



Select from the 30 colours
in the Aeria palette. Special colours
available on request.

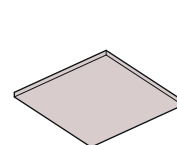

1,199 x 1,199 x 55 mm

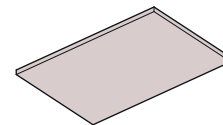

1,199 x 1,799 x 55 mm

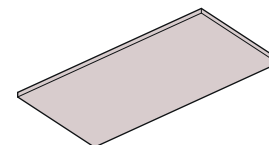

1,199 x 2,399 x 55 mm

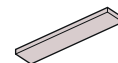

299 x 1,199 x 55 mm

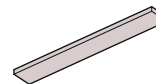

299 x 1,799 x 55 mm

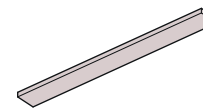

299 x 2,399 x 55 mm



599 x 599 x 55 mm

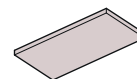

599 x 1,199 x 55 mm

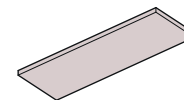

599 x 1,799 x 55 mm

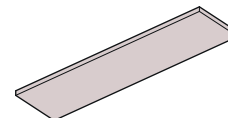

599 x 2,399 x 55 mm

Characteristics

ACCESSORIES

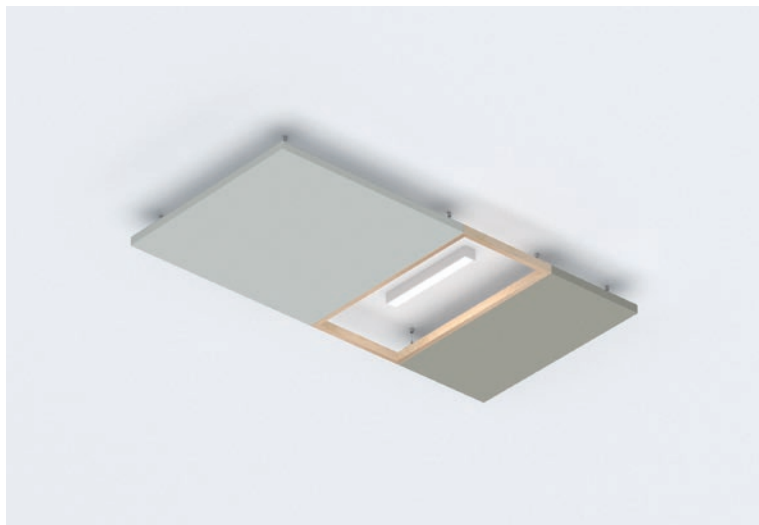

Frames

Empty frames made of maritime pine create a gap in the middle of a ceiling or between islands of panels. The dimensions of these frames provide enough room for different types of equipment (lights, video projectors, etc.).

Frame dimensions

Overall: 599 x 1,199 mm
Interior: 537 x 1,137 mm
Overall: 1,199 x 1,199 mm
Interior: 1,137 x 1,137 mm

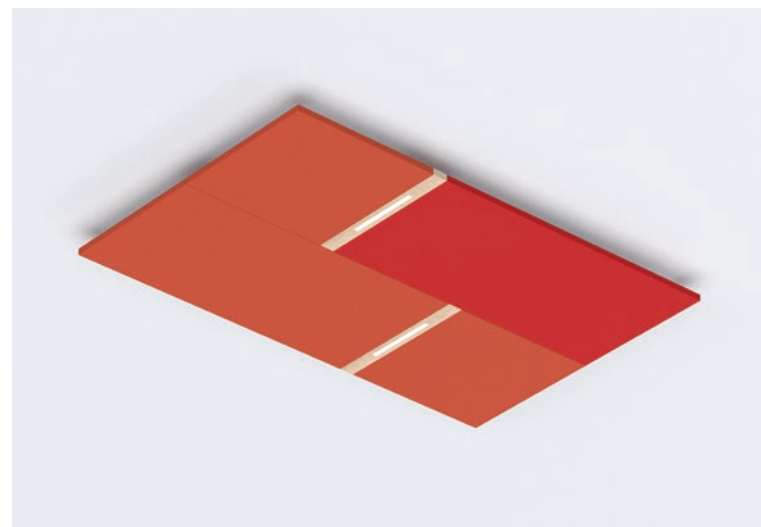
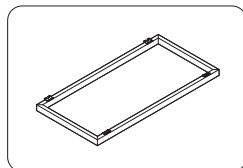

Equipment tray

Equipment trays made of maritime pine can be used to locate a range of equipment between two panels or in the middle of a ceiling. Recesses can be easily cut in these trays in our workshop or on site according to the dimensions below to accommodate round or rectangular shaped equipment.

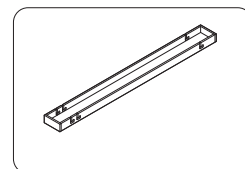

Equipment tray dimensions

Overall: 120 x 1,199 mm
Interior: 100 x 1,159 mm

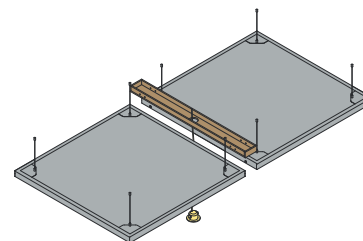

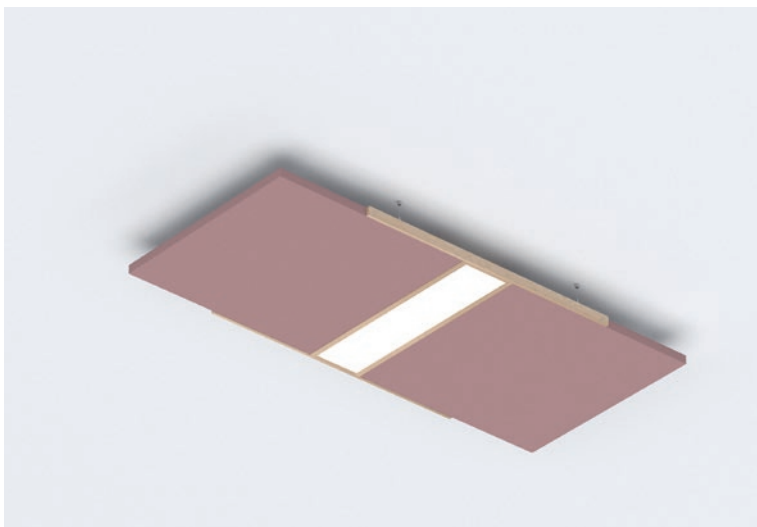

Platform

Positioned above a meeting table or a workstation, Texaa's acoustic lighting platform comprises two 1,200 x 1,200-mm Stereo acoustic panels fixed to a frame made of maritime pine, which enables different types of lighting to be accommodated: a light panel on the same level as the acoustic panels or a light hanging through the frame.

Dimensions of the equipment tray

Overall: 120 x 1,199 mm

Inside: 100 x 1,137 mm

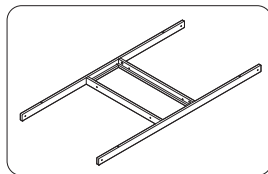

Spacers

Spacers make it possible to separate two Stereo panels simply and precisely. They have holes in the middle for a light rail to be attached. Actual fixture methods will depend on weight. Fixing a spacer between two panels requires no tools.

Black or white powder coated steel spacer

Thickness: 0.8 mm

Space between panels: 120 mm

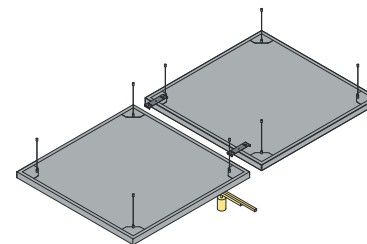
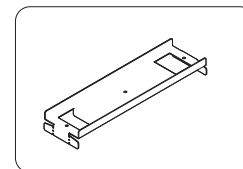

Maintenance

Strato ceilings are resistant to tearing and abrasion. The knot in their knitted stitch makes them run-free: any hole in the fabric will not get bigger.

With their antistatic coating, Strato ceilings are protected against dust and easy to maintain. Simple vacuum cleaning is enough to keep them bright and fresh. Texaa products last a very long time, often more than 20 years.



Run-free because of the knot in each stitch.



Resistant to wear: resists more than 30,000 cycles of the Martindale rub test NF EN 12947-2.



Antistatic and dustproof: $3.10^9 \Omega/m^2$ as tested applying ASTM D257.



Learn more:
texaa.com/servicing

→
A Strato ceiling consisting of Stereo Air open mesh panels on the same level as the drywall ceiling. The Black Tower Company, head office of website MaPeinturePro.com in Montelimar, south-eastern France.



Colours

Aeria is knitted in our workshop in Gradignan outside Bordeaux using a patented process. It is available in three stitch sizes and a range of 30 colours. Special colours can be supplied on request.



Order a sample:
texaa.com/samples



Gris Nacré
GMR003



Gris Anthracite
GMR006



Gris Nacré
MRE003



Gris Anthracite
MRE006



Beige Kaolin
MRE029



Bleu Opale
MR007



Bleu Arctique
MR021



Bleu Torrent
MR009

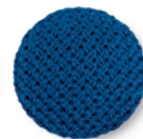

Bleu Royal
MR015



Bleu Pétrole
MR018



Vert Kaki
MR011



Vert Mousse
MR028



Pistache
MR008

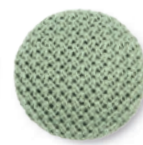

Sauge
MR025



Amande
MR017



Noir Carbone
MR001



Gris Anthracite
MR006



Chiné Écorce
MR019



Beige Pralin
MR002

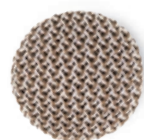

Chiné Taupe
MR023

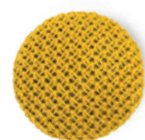

Jaune Impérial
MR016



Ocre
MR004



Cannelle
MR022



Ambre
MR010

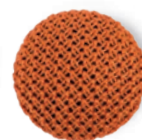

Terracotta
MR024

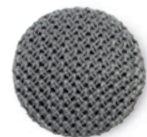

Gris Cendré
MR014



Gris Nuage
MR027



Gris Nacré
MR003



Crème
MR012



Beige Kaolin
MR029

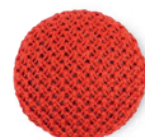

Vermillon
MR020

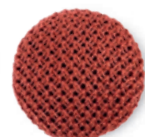

Rubis
MR013



Rouge Piment
MR030



Noisette
MR026



Châtaigne
MR005

Texaa®

Conceive and build your
solutions with **texaa.com**



UNITED KINGDOM

Becket House
1 Lambeth Palace Road
London SE1 7EU

+44 (0) 20 7092 3435
contact@texaa.co.uk
www.texaa.co.uk

FRANCE

43, allée Mégevie
33174 Gradignan

+33 (0) 5 56 75 71 56
contact@texaa.fr
www.texaa.fr

DEUTSCHLAND

Walter-Kolb-Straße 9-11
60594 Frankfurt am Main

+49 (0) 69 962 17 63 16
kontakt@texaa.de
www.texaa.de